



September 25, 2002

Darrow Mansfield
Stowe Health Officer
P.O. Box 216
Stowe, VT 05672

RE: Construction Permit Application
317 Lang Farm Road, Stowe
McCain Project No. 22074

Dear Darrow,

Enclosed please find two copies of the site plans, a fee check and a Town Construction Permit application for the above referenced project. Following your review and approval, please forward a copy of the permit to our office for our file.

Please feel free to call with any questions you may have or if you need any additional information.

Sincerely,
McCain Consulting, Inc.

A handwritten signature in black ink, appearing to read 'Nicole Fitch', with a large, stylized flourish at the end.

Nicole Fitch
Project Administrator

Enc.

Cc: Stephen & Carole Lichtenstein

Tax Map # Required!

TOWN of STOWE
Health Officer

PO Box 216
Stowe, Vermont 05672

(802) 253-6130

August 14, 1996

Mr. C. Paul Reed, Jr.
Sundown Corporation
PO Box 1078
Stowe, VT 05672

RE: Lichtenstein Septic
317 Lang Farm Road

Dear Paul:

We have received your plan for the Lichtenstein septic system. This letter acknowledges that this system has been repaired and your plan dated July 1996 is on file in this office.

Should this system ever fail, a new system designed by a registered Vermont engineer will be required.

Sincerely,



Leland G. Darrow, Jr.
Health Officer

LGD/rj

DATE SUBMITTED

FEE PAID

TOWN OF STOWE, VERMONT

PERMIT NUMBER

8.17.89

210.00

APPLICATION FOR ZONING PERMIT

Z-89-125

The undersigned hereby requests a zoning permit for the use or improvements described below, to be issued on the basis of the representations contained herein, and to be completed in accordance with Zoning Regulations of the Town of Stowe. Permit voided in the event of misrepresentation or failure to undertake construction within one year of the date of approval.

PROPERTY ADDRESS

STONE HOLLOW ROAD

(STREET, SUBDIVISION AND LOT NUMBER)

TAX MAP NUMBER

2.108

ZONING DISTRICT

RR5

PROPERTY OWNER NAME & ADDRESS

STEPHEN & CAROL LICHTENSTEIN

PHONE NUMBER

14 DARRAH LANE EAST.

WORK 609.883.2817

LAWRENCEVILLE, NEW JERSEY 08648

HOME 253.7408

APPLICANT NAME & ADDRESS

M.B. CUSHMAN DESIGN

PHONE NUMBER

BOX 655

WORK 253.2169

STOWE, VT. 05672

HOME 888.3362

BUILDER, NAME & PHONE NUMBER

BILL WILLIAMS

888.5087

EST. START OF CONSTRUCTION

SEPT. 6, 1989

COST OF CONSTRUCTION

\$10,000

A

B

SEWAGE DISPOSAL

PUBLIC ☐

SEWER PERMIT NUMBER

DATE

or PRIVATE ☒

HEALTH PERMIT NUMBER

N/R

DATE

1991

C

CURB CUT APPROVED BY SELECTMEN

N/R

DATE

D

LOT AREA

2.72

ACRES

BUILDING HEIGHT

22'-0"

(See Definition #8 of Zoning Regulations)

FRONT YARD SETBACK

132'

MEASUREMENT IN FEET FROM STREET LINE TO CLOSEST PORTION OF STRUCTURE — THIS INCLUDES PORCHES, DECKS, OVERHANGS, ETC. EXCEPT STEPS.

SHORTEST SIDE

86'

REAR YARD SETBACK

96'

E

PLOT PLAN

Please attach two copies of a plot plan in an appropriate scale (1"=50' recommended) showing the dimensions of the lot to be built on, location and plan outline (top view dimensions) of all existing buildings as well as the building(s) to be erected, altered, extended or moved. The existing or intended use of all buildings on the lot shall also be indicated on the plot plan.

G

SIGNATURE OF APPLICANT

[Signature]

DATE

8.15.89

FOR USE BY ADMINISTRATIVE OFFICER

Upon the representations contained herein, this application is hereby

APPROVED ☒DENIED ☐

A decision of the Administrative Officer may be appealed within 15 days of the date of decision. This permit does not take effect until the time for appeal has passed.

H

DATE OF DECISION

8/17/89

EFFECTIVE DATE

9/1/89

REMARKS/REASON FOR DENIAL

SIGNED

[Signature]

ADMINISTRATIVE OFFICER

YOU ARE REQUIRED TO POST YOUR WHITE PERMIT CARD IN A CONSPICUOUS PLACE ON THE CONSTRUCTION SITE.

F NATURE OF PROJECT

Check box(es) best describing the proposed use or construction

	Total New Construction	Addition to Existing Structure	Alteration
ONE-FAMILY DWELLING	<input type="checkbox"/>	<input type="checkbox"/>	<input type="checkbox"/>
TWO-FAMILY DWELLING	<input type="checkbox"/>	<input type="checkbox"/>	<input type="checkbox"/>
NUMBER BEDROOMS	<input type="checkbox"/>	<input type="checkbox"/>	<input type="checkbox"/>
NUMBER BATHROOMS	<input type="checkbox"/>	<input type="checkbox"/>	<input type="checkbox"/>
NUMBER KITCHENS	<input type="checkbox"/>	<input type="checkbox"/>	<input type="checkbox"/>
GARAGE (ATTACHED)	<input type="checkbox"/>	<input type="checkbox"/>	<input type="checkbox"/>
(DETACHED)	<input type="checkbox"/>	<input type="checkbox"/>	<input type="checkbox"/>
PORCH (OPEN)	<input type="checkbox"/>	<input type="checkbox"/>	<input type="checkbox"/>
(SCREENED)	<input type="checkbox"/>	<input type="checkbox"/>	<input type="checkbox"/>
(ENCLOSED)	<input type="checkbox"/>	<input type="checkbox"/>	<input type="checkbox"/>
DECK (S)	<input type="checkbox"/>	<input checked="" type="checkbox"/>	<input type="checkbox"/>
POOL (IN GROUND)	<input type="checkbox"/>	<input type="checkbox"/>	<input type="checkbox"/>
(ABOVE GROUND)	<input type="checkbox"/>	<input type="checkbox"/>	<input type="checkbox"/>
SHED	<input type="checkbox"/>	<input type="checkbox"/>	<input type="checkbox"/>
BARN	<input type="checkbox"/>	<input type="checkbox"/>	<input type="checkbox"/>
HOME OCCUPATION (describe)			

MOBILE HOME

☐

MISCELLANEOUS (describe below)

SEE ATTACHED SHEET

RENEWAL OF PERMIT NUMBER

August 17, 1989

Re: Addendum to the Lichtenstein Application for Zoning Permit

The scope of this application is to cover the following item of work:

1. Renovation and addition of one existing deck area and the replacing of an existing patio with a deck

In addition, the following items of work are to be accomplished in the same time frame:

2. Complete the drainage swale above the pond area to stabilize the banks from slumping.
3. Installation of foundation insulation and drainage systems to help prevent further deterioration of these below grade conditions.
4. Alteration of existing ground level bathroom, family room and utility areas.

SUNDOWN CORP.
P.O. Box 1078
STOWE, VERMONT 05672

2-108

Memo

LETTER

(802) 253-8261 244-6465
FAX (802) 244-6119

To LEE DARRAW - Health Officer
TOWN OF STOWE
STOWE VT 05672

Date

7/25/96

Subject

REPAIRED
SEPTIC SYSTEM

Hi LEE As we spoke, I'm sending
you AS BUILTS AND ORIGINAL PLOT
PLAN FOR STOWE LICHTENSTEIN HOME
ON FORMER "KITREN DWIGHT RD"

He HAS ASKED that you SEND
BACK SOME ACKNOWLEDGEMENT TO
THIS REPAIR MEETING your
CONSENT.

THANKS Paul
C.C. STOWE LICHTENSTEIN

☐ Please reply

☐ No reply necessary

SIGNED



W - 609 - 989 - 5007
LICHTENSTEIN SEPTIC
July '96

M. HUTCHINS
B. GELD

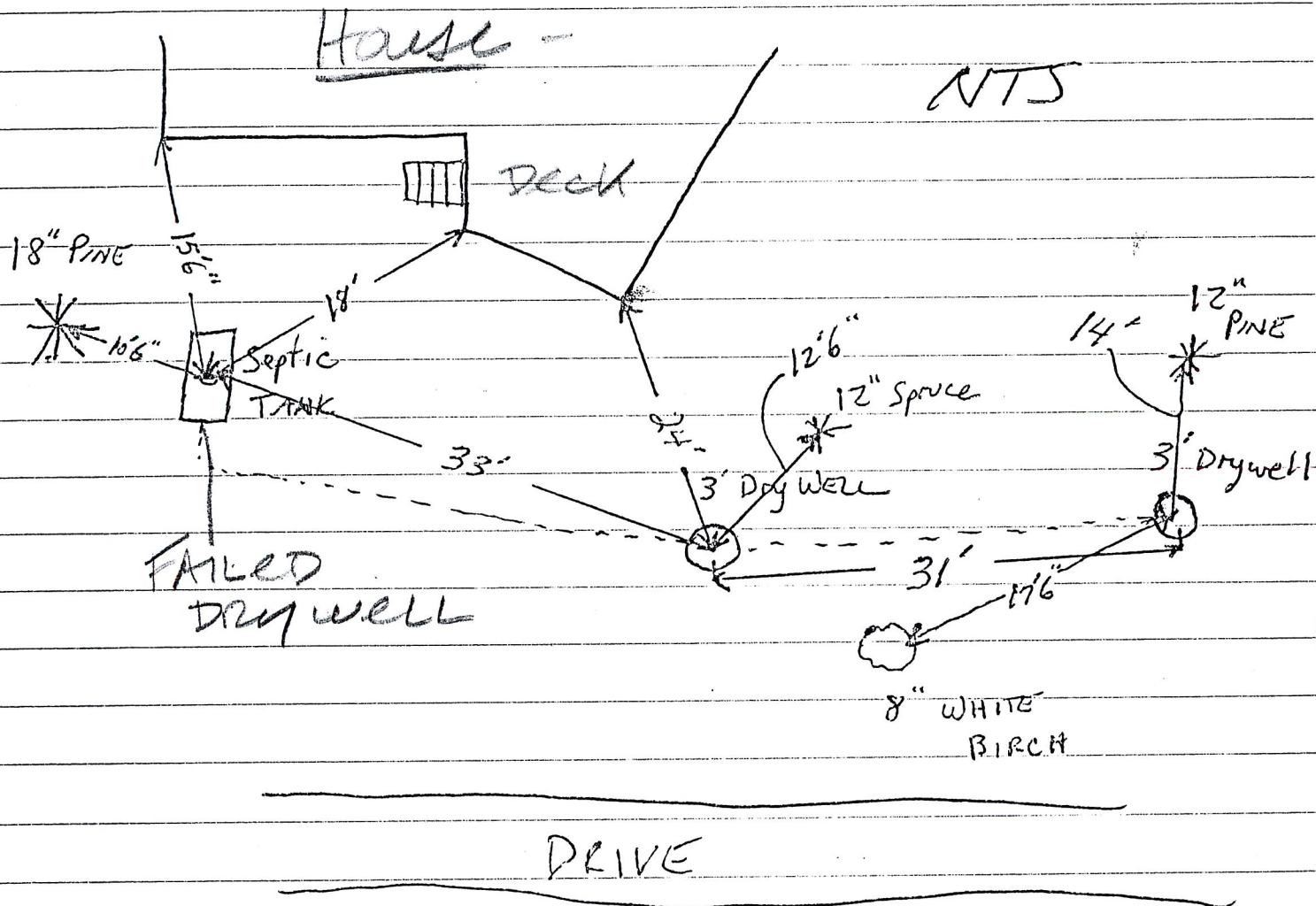

INSTALLER - SUNDOWN Corp
Box 1078
STAVE
253 - 8261